

Tc max=75°C Risk group(EN 62471:2008)=1

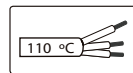

Installation cable must support 110°C temperature. Feeding cable must be cable pipe 3x1 mm<sup>2</sup> and 3x1,5 mm<sup>2</sup>. Installation may require

advice.



Not suitable for covering with thermally insulating material.



Do not accumulate excess of cable into the fixture.

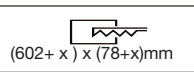

General safety instructions: information on restrictions related to use of the light fixtures (class, IP, etc), can be found both on the fixture label and on our website at [www.rovasi.com](http://www.rovasi.com).

The wiring schematics can be found on page 2 of the document.

ELECTRONIC EQUIPMENT:

**S:** On/Off .

**D:** DALI/DSI/switchDIM. There are accessories available for dimming devices.

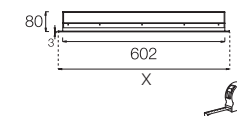

13.88W / 350mA

171ESR.1-1976  
171ESR.1-1977  
171ESR.1-1978

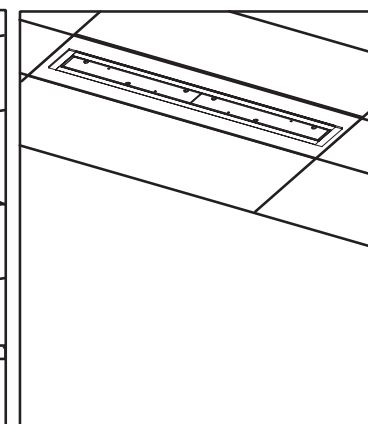
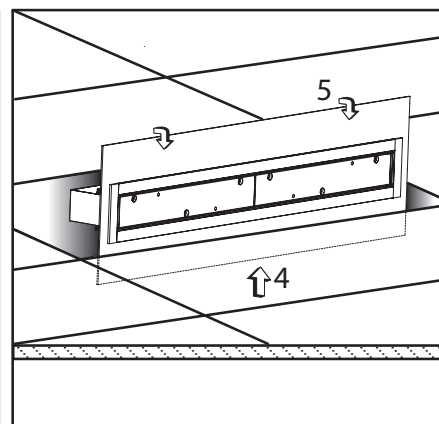
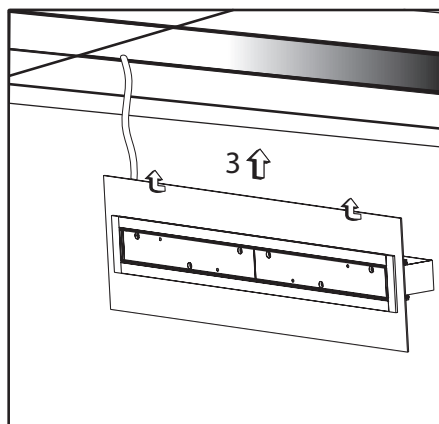
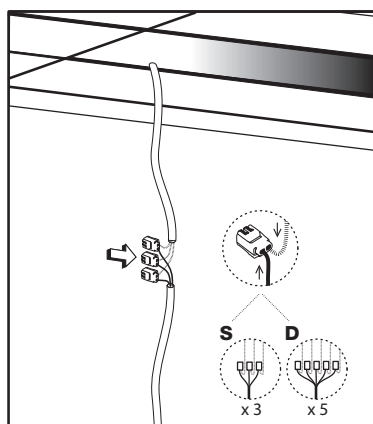
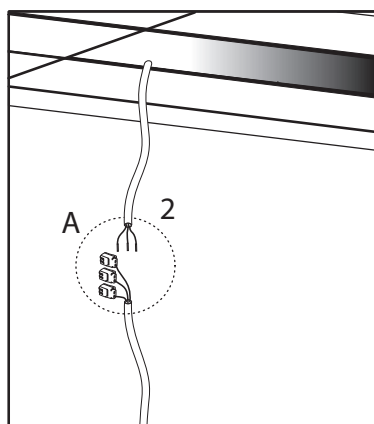

**This product contains a light source of energy efficiency class C.**

LED technology and performance data are constantly changing. Current details should therefore be checked with ROVASI in order to ensure that its still the most up to date reference. Updated data will be supplied on request. [21.03.2023]



BSI Cert ISO 9001:2015 - nºFM 39346  
BSI Cert ISO 14001:2015 - nºEMS 554685

Ronda de la Font-Grossa 15  
Pol. Ind. La Gavarra  
08540 Centelles | Barcelona  
Spain

T. 34 93 881 35 12  
T. 34 93 881 37 13

info@rovasi.com  
**rovasi.com**

## WIRING GUIDELINES

### Installation instructions. Mains supply wires

- Wiring type and cross section
- Solid wire with a cross section of 0.5 – 1.5 mm<sup>2</sup>.
- Strip 8-9mm of insulation from the cables to ensure perfect operation of the push terminals.
- Use one wire for each terminal connector only.
- Use each strain relief channel for one cable only.
- Installation may require advice from a qualified person.
- Single lights apt for indoor use (not outdoor).

### Wire preparation:

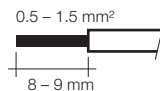

### Wiring guidelines

- All connections must be kept as short as possible to ensure good EMI behaviour.
- Earthing is not required for the device to operate but will improve the EMI behaviour.
- The max. secondary cable length is 2m (4m circuit).
- Secondary switching is not permitted.
- Incorrect wiring can damage LED modules.



Loose wire through twisting and pulling or using a Ø1mm release tool.

Circuit diagram S: Standard ON/OFF

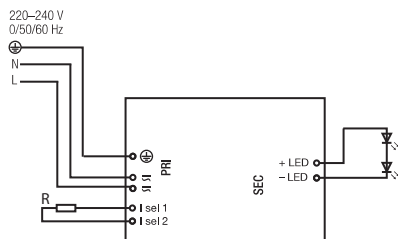

Circuit diagram D: DALI/DSI/SwitchDIM/corridorFUNCTION

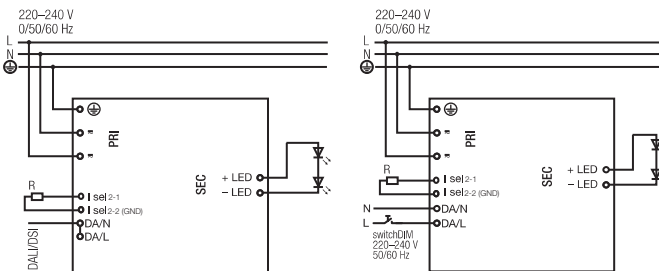

Circuit diagram A: 1-10V [to consult]

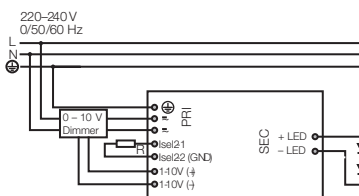

Circuit diagram DB: DALI

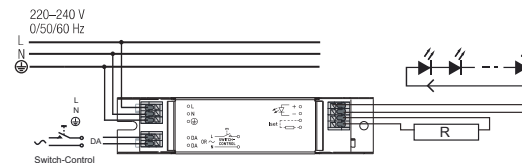

## UPGRADEABLE, REPLACEABLE, REPAIRABLE



The servicing of the light source in this luminaire should only be undertaken by the manufacturer or his service agent or a similar qualified person.

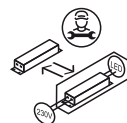

The servicing of the driver in this luminaire should only be undertaken by the manufacturer or his service agent or a similar qualified person.

1

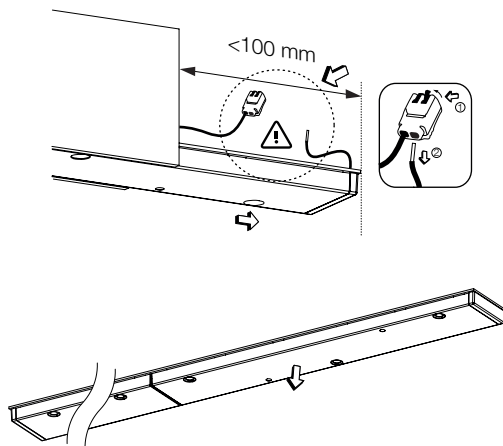

2

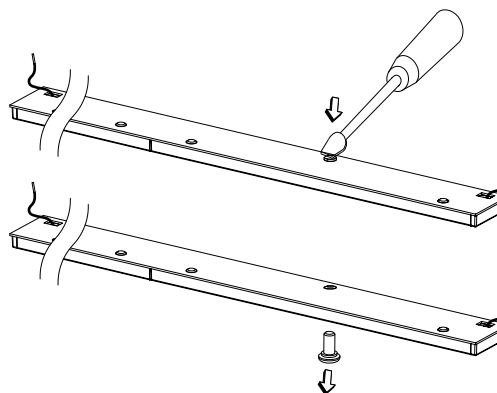

3

