

Tc max=85°C Risk group(EN 62471:2008)=1

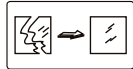

Fitting must only be used complete with their protection cover. Tempered safety glass or polycarbonate cover of dimensions 120ext106int mm and 116 mm thickness.

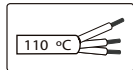

Installation cable must support 110°C temperature. Feeding cable must be cable pipe 3x1 mm². Instalation may require advice.



Do not acumulate excess of cable into the fixture.



3.56Kg

General safety instructions: information on restrictions related to use of the light fixtures (class, IP, etc), can be found both on the fixture label and on our website at www.rovasi.com.

The wiring schematics can be found on page 2 of the document.

ELECTRONIC EQUIPMENT:

S: On/Off .

D: DALI. There are accessories available for dimming devices.

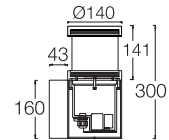

10.6W / 500mA

420UND.4-I1105
420UND.4-I1106

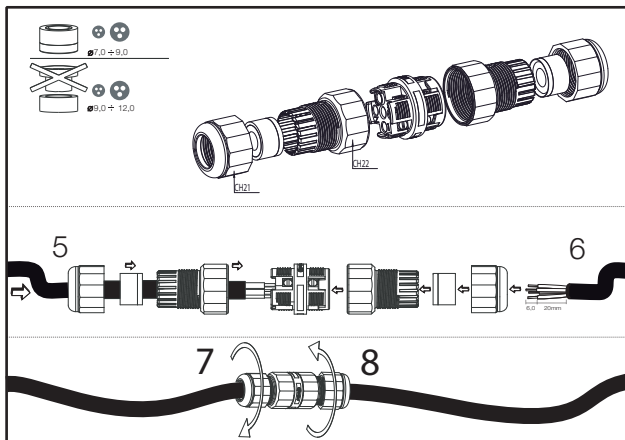

This product contains a light source of energy efficiency class E.

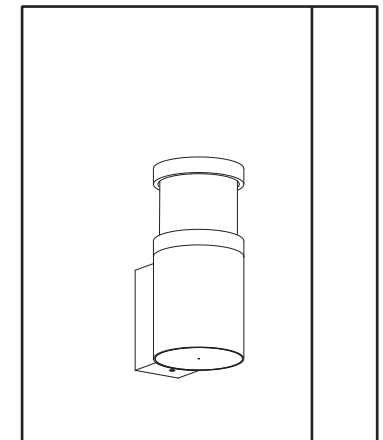
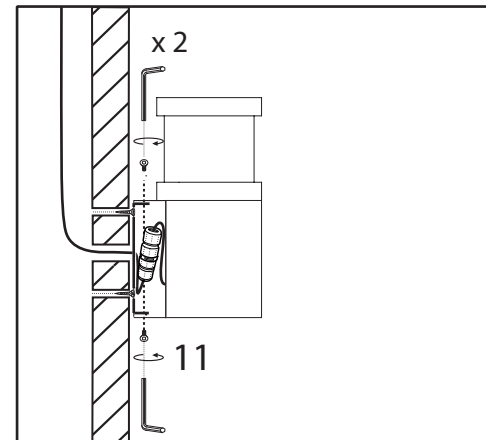
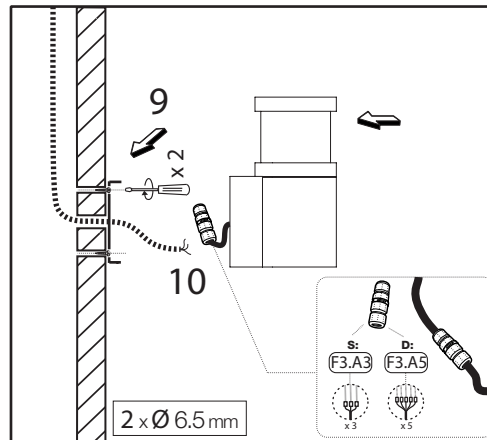

WIRING GUIDELINES

Installation instructions. Mains supply wires

- Wiring type and cross section
- Solid wire a cross section of 0.2 - 1.5mm². Strip 8,5-9,5 mm of insulation from the cables to ensure perfect operation of terminals.
- Use one wire for each terminal connector only.
- Use each strain relief channel for one cable only.
- Installation may require advice from a qualified person.
- Single lights apt for outer use.

Wiring guidelines

- The cables should be run separately from the mains connections and mains cables to ensure good EMC conditions.
- The max. secondary cable length is 2m (4m circuit). Secondary switching is not permitted.
- Incorrect wiring can damage LED modules.
- The LED Driver has no inverse-polarity protection on the secondary side. Wrong polarity can damage led modules with no inverse-polarity protection.



Release of the wiring
Press down the "push button"
and remove the cable from front

Circuit diagram S:Electronic constant current drivers



Circuit diagram DB:DALI

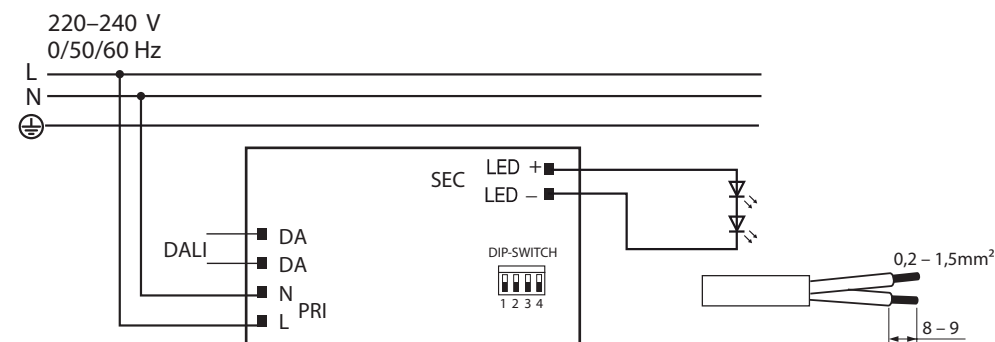

REPAIR AND REPLACEMENT



The light source contained in this luminaire shall only be replaced by the manufacturer or his service agent or a similar qualified person.



The driver contained in this luminaire shall only be replaced by the manufacturer or his service agent or a similar qualified person.

1



2

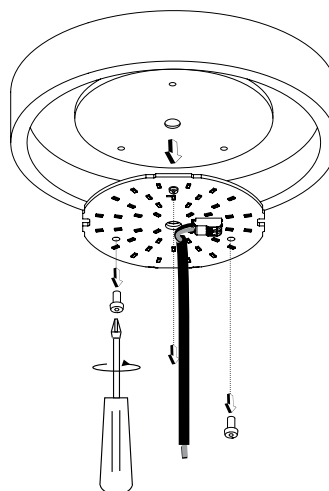

3

