

101EFF.1.04-R871

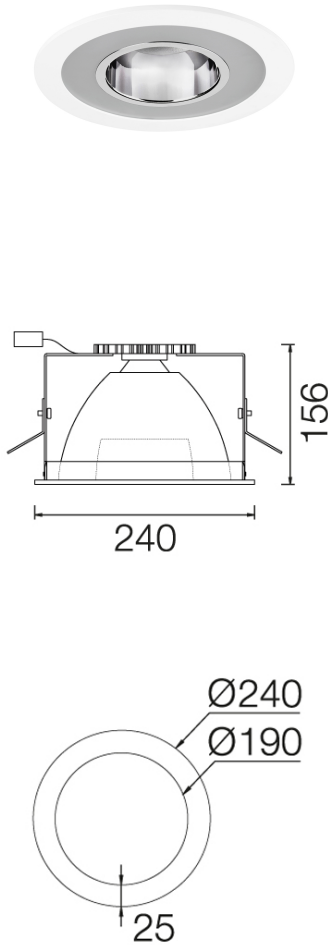

Recessed ceiling-mounted downlight with symmetrical light distribution to achieve an effective general lighting.
Circular design in a diameter of 240mm.
Metalized aluminium reflectors. Interior reflector: sandblasted. Exterior reflector: specular.
Double die-cast aluminium trim and glass diffuser with internal reflector to direct the light.
Powder painted die-cast aluminium trim available in assorted various, customized RAL under request.
Flush painted glass diffuser easily attached to the reflector.
Tridonic remote driver supplied.
Electronic options for lighting control: DALI-2.
3 hours battery available as option (class I).
Passive temperature management: heat dissipation flows through aluminium heat sink.
Ceiling-mounted using galvanised steel support with screws, ceiling thickness up to 30mm.

Luminaire luminous flux: 1884lm
Luminaire connected power: 18.33 W
Luminaire efficiency: 103 lm/W
Light source luminous flux: 2990lm
Light source power: 17 W
Constant Current: 500 mA
CRI: >80
Colour Temperature: 4000K
Chromaticity Tolerance: MacAdam 3
Beam Angle: 19°
LOR: 63%
Average Service Life: 50000h
LED reliability: 50000h L90B10
UGR: <19
Photobiological safety group: 1
Cd/Klm: 2325
Imax: 6952 Cd
This product contains a light source of energy efficiency class D

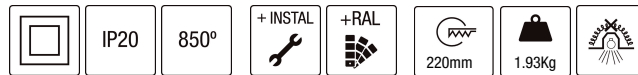
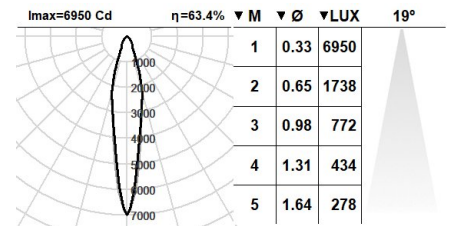

Electronic Equipment

K: On/Off (basic)
S: On/Off (AC/DC + looping through)
SE: On/Off (AC/DC+looping) + 3h battery
D: DALI-2/switchDIM/corridorFUNCTION
DE: DALI-2/switchDIM/corridorFUNCTION + Battery 3h
B: Bluetooth-Casambi

*Add the suffix **-K, -S, -SE, -D, -DE, -B** after the reference to indicate your electronic equipment choice.

Finishes

2: RAL9005: Jet Black, **4:** RAL7016: Anthracite Grey, **7:** RAL9006: White Aluminium, **1:** RAL9010: Pure White

Upgradeable, Replaceable, Repairable

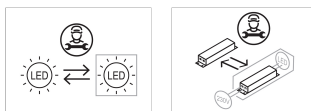

Note

LED technology and performance data are constantly changing. Current details should therefore be checked with ROVASI in order to ensure that it is still the most up to date reference. Updated data will be supplied on request. [Last revised on 07.05.2024]

5 years guarantee



BSI Cert ISO 9001:2015 - n°FM 39346
BSI Cert ISO 14001:2015 - n°EMS 554685

ROVASI S.L.

Ronda de la Font Grossa, 15
Pol. Ind. La Gavarra
08540 Centelles | Barcelona
Spain

Contact

T. +34 93 881 35 12 info@rovasi.com
T. +34 93 881 37 13 www.rovasi.com