

## 103EFF.1.04-R892

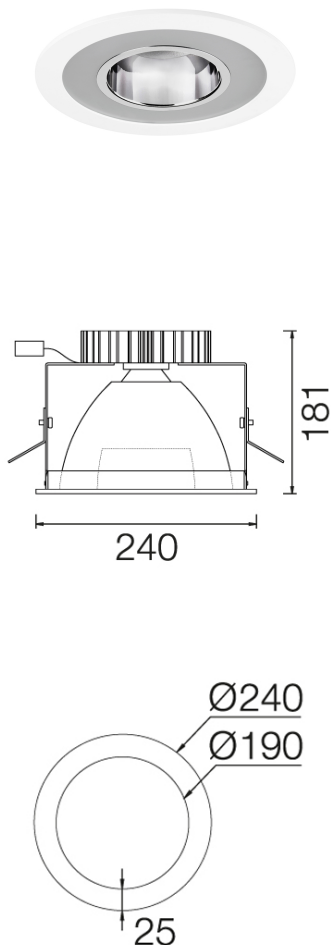

Recessed ceiling-mounted downlight with symmetrical light distribution to achieve an effective general lighting.

Circular design in a diameter of 240mm.

Metalized aluminium reflectors. Interior reflector: sandblasted. Exterior reflector: specular.

Double die-cast aluminium trim and glass diffuser with internal reflector to direct the light.

Powder painted die-cast aluminium trim available in assorted various, customized RAL under request.

Flush painted glass diffuser easily attached to the reflector.

Tridonic remote driver supplied.

Electronic options for lighting control: DALI-2.

The driver contained in this luminaire complies with European Directive 2009/125/EC establishing flicker limits:  $PstLM \leq 1$  and  $SVM \leq 0.4$ .

3 hours battery available as option (class I).

Passive temperature management: heat dissipation flows through aluminium heat sink.

Ceiling-mounted using galvanised steel support with screws, ceiling thickness up to 30mm.

**Luminaire luminous flux:** 3065lm

**Luminaire connected power:** 38.97 W

**Luminaire efficiency:** 79 lm/W

**Light source luminous flux:** 5285lm

**Light source power:** 35 W

**Constant Current:** 1050 mA

**CRI:** >90

**Colour Temperature:** 4000K

**Chromaticity Tolerance:** MacAdam 3

**Beam Angle:** 24°

**LOR:** 58%

**Average Service Life:** 50000h

**LED reliability:** 50000h L90B10

**UGR:** <19 under the below indicated parameters

Room dimensions X=4H/8H

Reflectance 20% | 50% | 70%

Luminaire spacing = 0.3m

**Photobiological safety group:** 1

**Cd/Klm:** 1779

**Imax:** 9402 Cd

**This product contains a light source of energy efficiency class E**

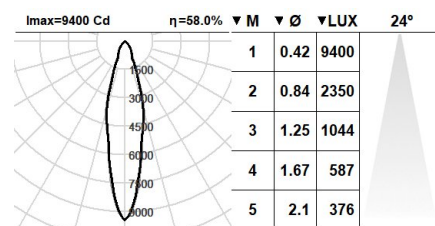

### Electronic Equipment

**K:** On/Off (basic)

**S:** On/Off (AC/DC + looping through)

**SE:** On/Off (AC/DC+looping) + 3h battery

**D:** DALI-2/switchDIM/corridorFUNCTION

**DE:** DALI-2/switchDIM/corridorFUNCTION + Battery 3h

**B:** Bluetooth-Casambi

\*Add the suffix **-K**, **-S**, **-SE**, **-D**, **-DE**, **-B** after the reference to indicate your electronic equipment choice.

### Finishes

**4:** RAL7016: Anthracite Grey, **1:** RAL9010: Pure White, **2:** RAL9005: Jet Black, **7:** RAL9006: White Aluminium

### Upgradeable, Replaceable, Repairable



### Note

LED technology and performance data are constantly changing. Current details should therefore be checked with ROVASI in order to ensure that it is still the most up to date reference. Updated data will be supplied on request. [Last revised on 09.05.2025]

### 5 years guarantee



BSI Cert ISO 9001:2015 - n°FM 39346

BSI Cert ISO 14001:2015 - n°EMS 554685

### ROVASI S.L.

Ronda de la Font Grossa, 15  
Pol. Ind. La Gavarra  
08540 Centelles | Barcelona  
Spain

### Contact

T. +34 93 881 35 12  
T. +34 93 881 37 13

info@rovasi.com

www.rovasi.com