

PINHOLE SEAL

IP65 Small recessed downlights

ROVASI
Positive Lighting

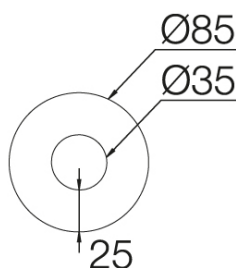
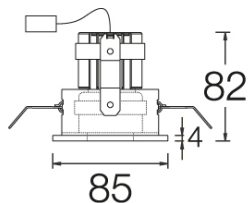

107PNS.1.01-R640



Small recessed ceiling-mounted downlight with symmetrical light distribution to achieve an effective accent lighting.

Protection rating against dust and moisture: IP65 from underneath.

Circular design in diameter 85mm, circular interior aperture in diameter 35mm.

Internal cylindrical aluminium black baffle for minimal glare.

Deep regressed module to ensure visual comfort.

Powder painted trim available in assorted finishes, customized RAL under request.

Glass and silicone ring to increase the IP protection to IP65 from underneath.

Honeycomb anti-dazzle screen accessory to increase visual comfort [reference M6.A0050].

Remote driver included.

Electronic options for lighting control: DALI-2.

The driver contained in this luminaire complies with European Directive 2009/125/EC establishing flicker limits: PstLM ≤ 1 and SVM ≤ 0.4.

3 hours battery available as option.

Passive temperature management: heat dissipation flows through an aluminium heat sink.

Ceiling-mounted by spring clamps for easy installation, ceiling thickness up to 25mm.

Luminaire luminous flux: 622lm

Luminaire connected power: 9.77 W

Luminaire efficiency: 64 lm/W

Light source luminous flux: 840lm

Light source power: 8.8 W

Constant Current: 250 mA

CRI: >90

Colour Temperature: 3000K

Chromaticity Tolerance: MacAdam 3

Beam Angle: 25°

LOR: 74%

Average Service Life: 50000h

LED reliability: >50000h L70B50

UGR: <16

Photobiological safety group: 1

This product contains a light source of energy efficiency class F

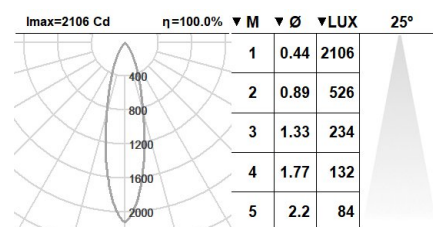

Electronic Equipment

K: On/Off (basic)

S: On/Off (AC/DC)

SE: On/Off (AC/DC) + Battery 3h

D: DALI-2/switchDIM/corridorFUNCTION

DE: DALI-2/switchDIM + 3h battery

B: Bluetooth-Casambi

*Add the suffix **-K**, **-S**, **-SE**, **-D**, **-DE**, **-B** after the reference to indicate your electronic equipment choice.

Finishes

1: RAL9010: Pure White, **2:** RAL9005: Jet Black, **4:** RAL7016: Anthracite Grey, **7:** RAL9006: White Aluminium

Upgradeable, Replaceable, Repairable



Note

LED technology and performance data are constantly changing. Current details should therefore be checked with ROVASI in order to ensure that it is still the most up to date reference. Updated data will be supplied on request. [Last revised on 01.05.2025]

5 years guarantee



BSI Cert ISO 9001:2015 - n°FM 39346

BSI Cert ISO 14001:2015 - n°EMS 554685

ROVASI S.L.

Ronda de la Font Grossa, 15
Pol. Ind. La Gavarra
08540 Centelles | Barcelona
Spain

Contact

T. +34 93 881 35 12 info@rovasi.com
T. +34 93 881 37 13 www.rovasi.com