

101EFF.1.04-R870



Recessed ceiling-mounted downlight with symmetrical light distribution to achieve an effective general lighting.

Circular design in a diameter of 240mm.

Metalized aluminium reflectors. Interior reflector: sandblasted. Exterior reflector: specular.

Double die-cast aluminium trim and glass diffuser with internal reflector to direct the light.

Powder painted die-cast aluminium trim available in assorted various, customized RAL under request.

Flush painted glass diffuser easily attached to the reflector.

Tridonic remote driver supplied.

Electronic options for lighting control: DALI/DSI.

3 hours battery available as option (class I).

Passive temperature management: heat dissipation flows through aluminium heat sink.

Ceiling-mounted using galvanised steel support with screws, ceiling thickness up to 30mm.

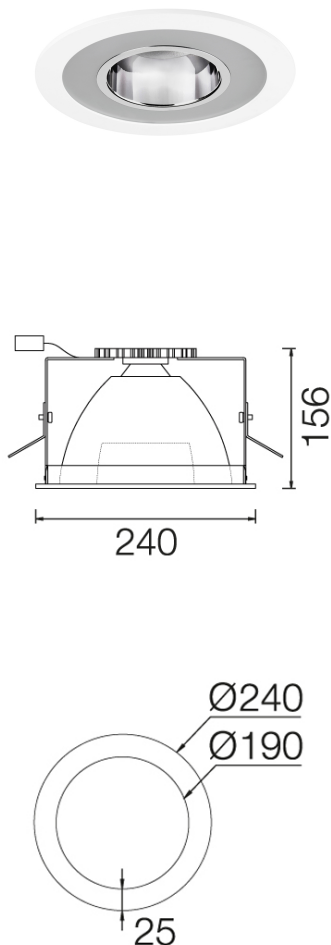

Light source power: 17 W

Fixture power: 18.33 W

Constant Current: 500 mA

Luminous flux of the light source: 2870lm

Luminous flux of the fixture: 1808lm

CRI: >80

Colour Temperature: 3000K

Chromaticity Tolerance: MacAdam 3

Beam Angle: 19°

LOR: 63%

Average Service Life: 50000h

LED reliability: 50000h L90B10

UGR: <19

Photobiological safety group: 1

Cd/Klm: 2325

Luminous efficacy: 99 lm/W

Imax: 6673 Cd

This product contains a light source of energy efficiency class D

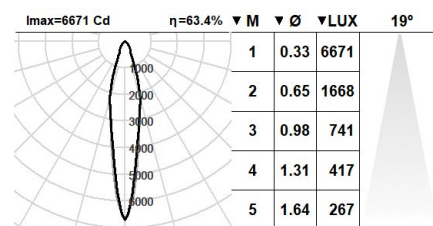

Electronic Equipment

K: On/Off (basic)

S: On/Off (AC/DC + looping through)

SE: On/Off (AC/DC+looping) + 3h battery

D: DALI-2/DSI switchDIM/corridorFUNCTION

DE: DALI-2/DSI switchDIM/corridorFUNCTION + Battery 3h

*Add the suffix **-K, -S, -SE, -D, -DE** after the reference to indicate your electronic equipment choice.

Finishes

2: RAL9005: Jet Black, **4:** RAL7016: Anthracite Grey, **7:** RAL9006: White Aluminium, **1:** RAL9010: Pure White

Upgradeable, Replaceable, Repairable



Note

LED technology and performance data are constantly changing. Current details should therefore be checked with ROVASI in order to ensure that it is still the most up to date reference. Updated data will be supplied on request. [Last revised on 17.04.2024]

5 years guarantee



BSI Cert ISO 9001:2015 - n°FM 39346

BSI Cert ISO 14001:2015 - n°EMS 554685

ROVASI S.L.

Ronda de la Font Grossa, 15
Pol. Ind. La Gavarra
08540 Centelles | Barcelona
Spain

Contact

T. +34 93 881 35 12 info@rovasi.com
T. +34 93 881 37 13 www.rovasi.com